



Ethelred Gardens, Wickford

£400,000

- Lounge/Diner 25'10 x 11'6
- Kitchen 10'8 x 8'2
- Refitted Bathroom
- Detached Garage
- Conservatory 14'2 x 7'2
- 3 First Floor Bedrooms
- Large Rear Garden
- Driveway

3 BEDROOM SEMI-DETACHED WITH LARGE REAR GARDEN. DETACHED GARAGE. 25'10 LOUNGE/DINER. 14'2 CONSERVATORY. 10'8 KITCHEN. Situated in a popular and established location on the Swan Lane side of Wickford set within easy access of town centre and mainline station is this 3 bedroom semi-detached property benefitting from large rear garden. The property's accommodation includes lounge/diner 25'10 x 11'6, conservatory 14'2 x 7'2, kitchen 10'8 x 8'2, 3 first floor bedrooms and refitted bathroom. The property's specification includes double glazed windows and gas fired radiator heating (untested) large rear garden, detached garage via a shared driveway and off street parking.



Council Tax Band:



Double glazed French doors to:

ENTRANCE PORCH

Double glazed windows to sides. Double glazed door to:

ENTRANCE HALL

Double glazed opaque window to side. Radiator (untested). Coved ceiling.

LOUNGE/DINER

25'10" x 11'6"

Double glazed window to front. Two radiators (untested). Fireplace. Coved ceiling. Double glazed patio doors to:

CONSERVATORY

14'2" x 7'2"

Brick base with double glazed windows to sides and rear. Double glazed French doors to rear garden. Tiling to floor.

KITCHEN

10'8" x 8'2"

Double glazed windows to side and rear. Range of base and wall mounted units providing drawer and cupboard space with worktop surface extending to incorporate inset sink unit with cupboard beneath. Built in oven, hob and extractor fan above (all untested). Larder cupboard. Recess for fridge. Tiled surround. Coved ceiling.

FIRST FLOOR LANDING

Double glazed opaque window to side. Airing cupboard. Coved ceiling. Access to loft which we understand is boarded with ladder.

BEDROOM ONE

11'7" x 10'0"

Double glazed window to front. Coved ceiling. Radiator (untested). Mirror fronted fitted wardrobe cupboards.

BEDROOM TWO

11'0" x 9'2"

Double glazed window to rear. Radiator (untested). Coved ceiling. Fitted wardrobe cupboards.

BEDROOM THREE

7'4" x 7'0"

Double glazed window to front. Radiator (untested). Fitted wardrobe cupboards and drawers.

REFITTED BATHROOM

Double glazed opaque windows to rear and side. Refitted enclosed low level WC, vanity wash hand basin and panel enclosed bath unit. Extensive tiled surround. Radiator (untested). Coved ceiling.

LONG REAR GARDEN

2 sheds incorporating workshop. Greenhouse. Vegetable patch. Large lawn area with flower and shrub borders.

DETACHED GARAGE

The property benefits from shared access to a detached garage and a driveway providing off street parking.



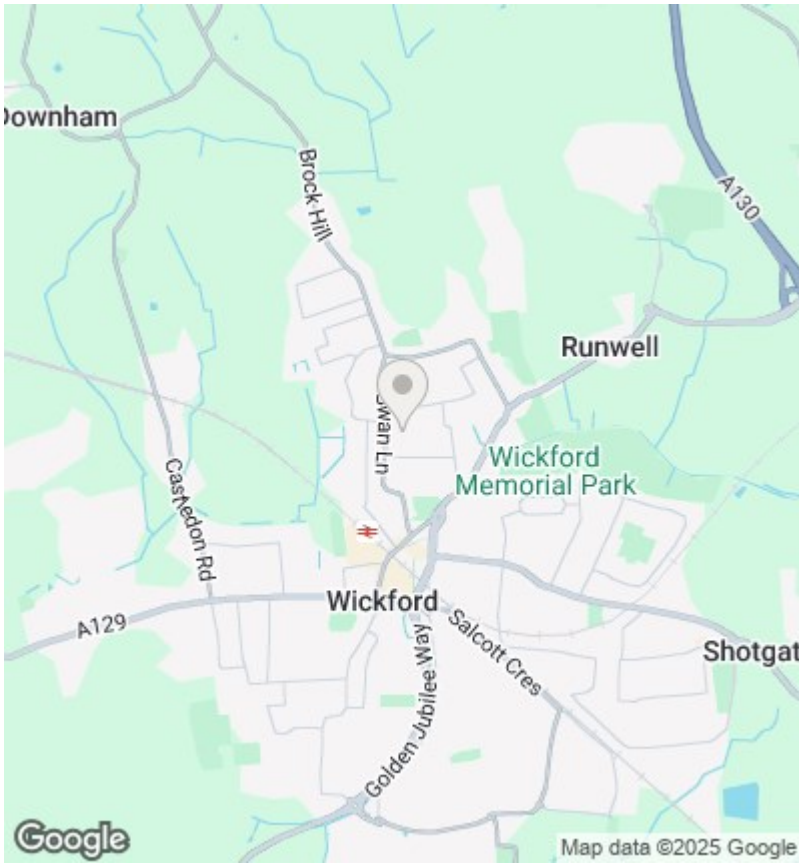

EPC Rating:

D

Energy Efficiency Rating		
	Current	Potential
<i>Very energy efficient - lower running costs</i>		
(92 plus) A		
(81-91) B		
(69-80) C		
(55-68) D	57	80
(39-54) E		
(21-38) F		
(1-20) G		
<i>Not energy efficient - higher running costs</i>		
England & Wales	EU Directive 2002/91/EC	

GROUND FLOOR

1ST FLOOR

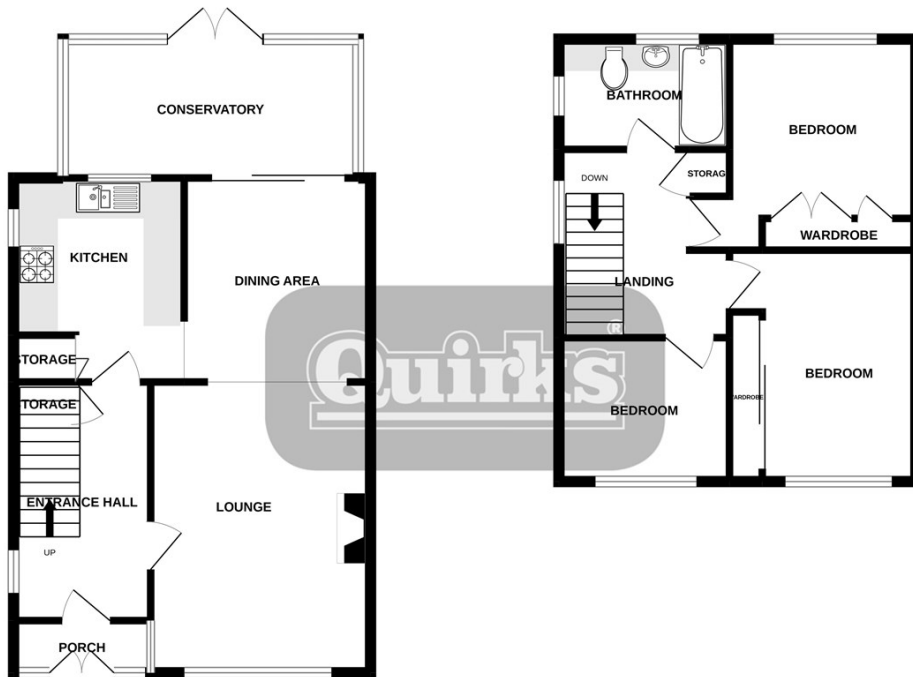

This floor plan is for illustrative purposes only. All representations including measurements, doors, windows and fixtures are approximate and NOT to scale. The total floor area includes all floor space associated with the property including garages and outbuildings as depicted. No appliances or services have been tested. Metropix ©2017
Made with Metropix ©2022